

# **GENERAL INSTALLATION OF A DAS CORNICE**

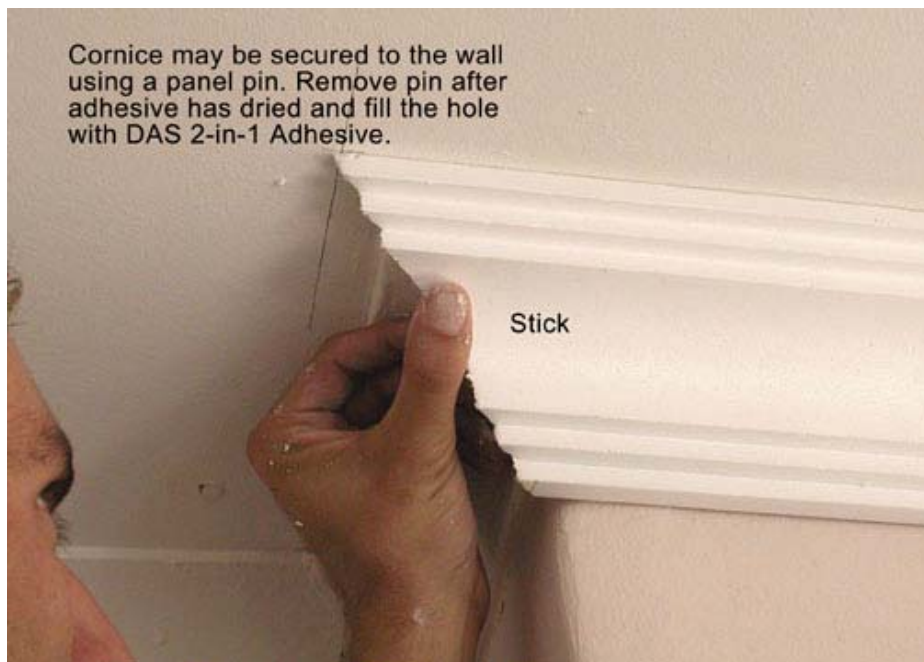

Cornice may be secured to the wall using a panel pin. Remove pin after adhesive has dried and fill the hole with DAS 2-in-1 Adhesive.



Use a damp sponge or cloth to remove excess adhesive. Don't wait for it to dry.



Secure cornice with panel pin until dry.



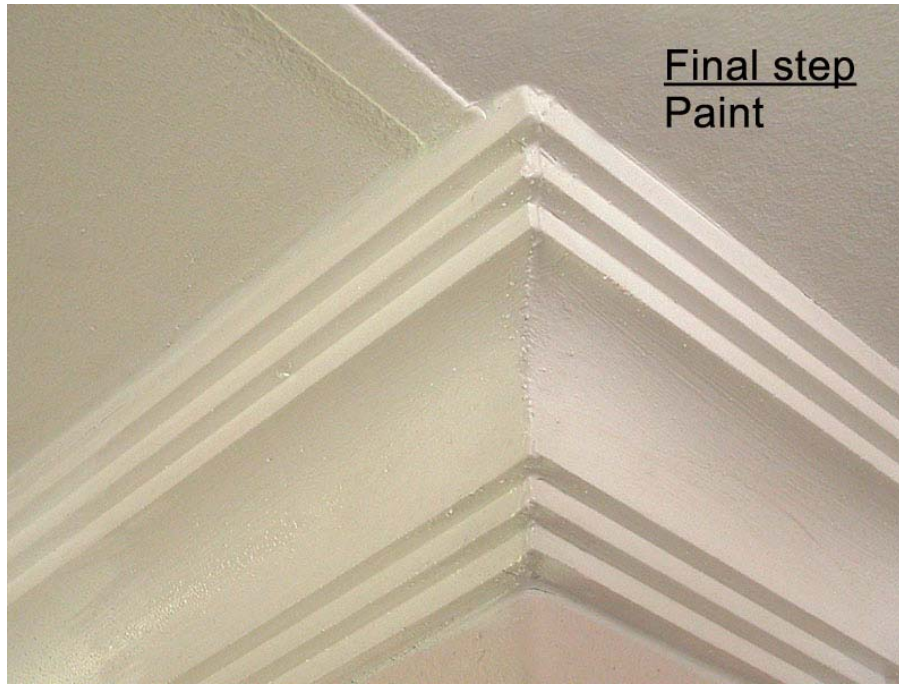

**Your Cornice should  
now be successfully  
installed.**